



SP series, made with UL compliant materials, supports you reaching **worldwide markets**. It offers you a **long-life reliable solution** for your needs with a **wide range of versions** designed for **small and big refrigeration systems** ensuring **great performances**.

### TECHNICAL SPECIFICATIONS

- Category** AGITATOR-PUMP with immersed vertical axis.
- Windings** Single-phase motor. Insulation Class F.
- Motor body** Extruded aluminium casing.
- Protection** IP 44 ingress protection rating.
- Safety** Built-in thermal motor protection system.
- Ball bearings** Ø 8 mm NSK, SKF or equivalent, in semi-rigid noise-damping silicone casing.
- Motor shaft** AISI 303 INOX steel Ø 8 mm.
- Fastening parts** INOX steel or corrosion-resistant materials.
- Motor parts** Thermoplastic motor parts resistant to high temperature complying to UL regulation.
- Cooling system** Air cooled pump with a suction speed of 2,2 m/s.
- Water connection** Compatible with John Guest fittings.
- Operation** Power supply 110-115 or 220 Volts - 24 hours a day non stop. Clean non drinkable water only.
- Regulations** Complying with EN60335-2-41:2003/A2:2010 and WEEE/RoHs directives.
- Note** **Italian PATENTED component installed inside.** Read the instruction booklet for correct set up and use.

### AVAILABLE FIXING PLATES

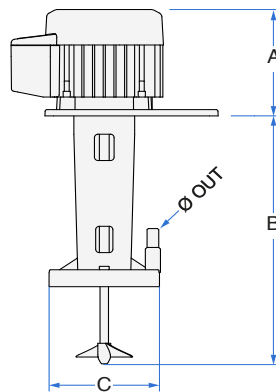
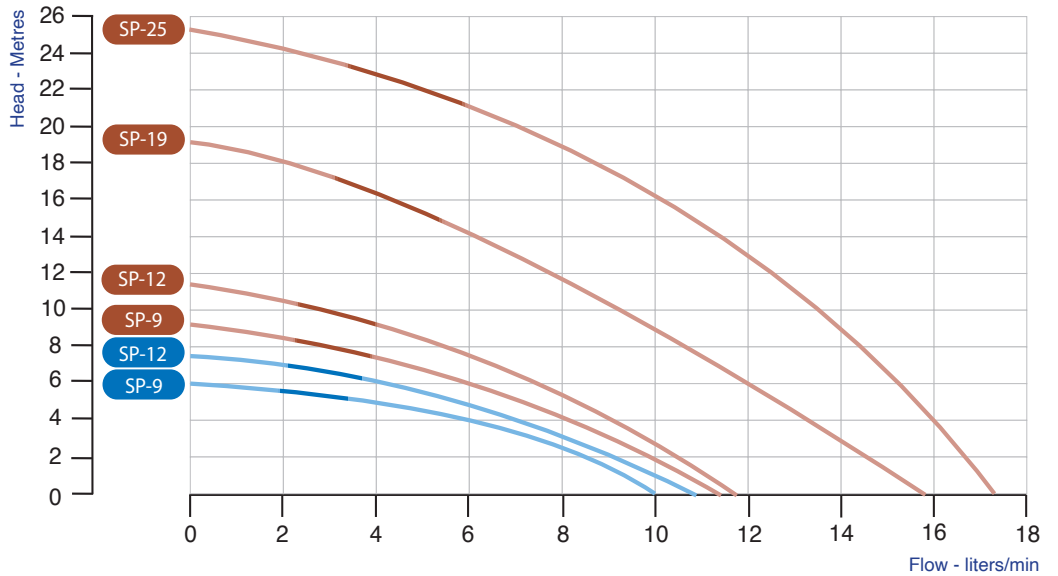
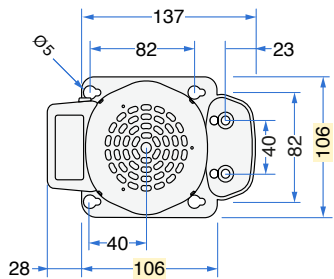
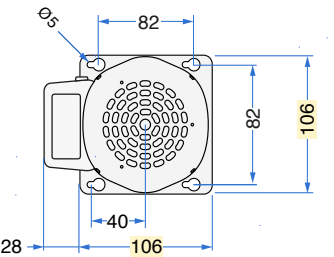
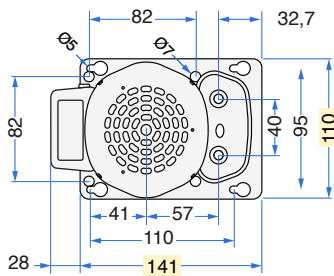
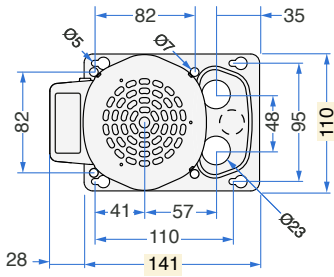

TYPE	Volt	Hz	Amp	Watt (In)	RPM	A	B	C	Ø OUT	Propeller Ø [mm]	Weight [Kg]
SP-9	110-115	50-60	0,60-0,57	56-62	2850-3300	90	185	78	9,5	50x15° 2 Blades	1,5
SP-12	110-115	50-60	0,82-0,77	73-72	2900-3400	105	220	90	9,5/12,3	50x15° 2 Blades	1,8
SP-19	110-115	60	1,35	113	3500	120	240	90	9,5/12,3	50x15° 2 Blades	2,4
SP-25	110-115	60	1,35	169	3450	140	240	90	9,5/12,3	50x15° 2 Blades	3
SP-9	220	50-60	0,31-0,28	63-66	2800-3300	90	185	78	9,5	50x15° 2 Blades	1,5
SP-12	220	50-60	0,37-0,32	67-71	2900-3450	105	220	90	9,5/12,3	50x15° 2 Blades	1,8
SP-19	220	60	0,49	107	3450	120	240	90	9,5/12,3	50x15° 2 Blades	2,4
SP-25	220	60	0,73	155	3450	140	240	90	9,5/12,3	50x15° 2 Blades	3

Rev. 21-02 Performance and electrical data have been tested at 20°C with clean water only. The company reserves the right to modify specifications without prior notice.