

AVAILABLE FIXING PLATES

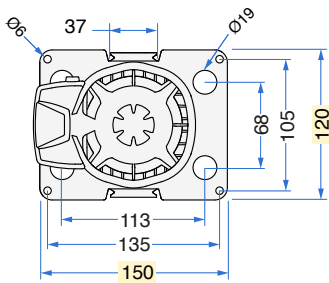

DBS Multi Flow series extends the advantages of the DBS reversed ventilation design adding **multiple outlets**. It is the perfect solution for **multiple-tower installations** where you need to fit only one pump in a compact space.

TECHNICAL SPECIFICATIONS

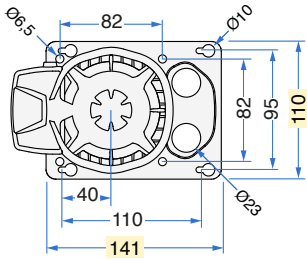

- Category** AGITATOR-PUMP with immersed vertical axis.
- Windings** Single-phase motor. Insulation Class F.
- Motor body** Extruded aluminium casing.
- Protection** IP 44 ingress protection rating.
- Safety** Built-in thermal motor protection system.
- Ball bearings** Ø 8 mm (12 mm optional) NSK /SKF or equivalent, in semi-rigid noise-damping silicone casing.
- Motor shaft** AISI 303 INOX steel Ø 8mm.
- Fastening parts** INOX steel or corrosion-resistant materials.
- Motor parts** Thermoplastic motor parts resistant to high temperature.
- Cooling system** Air cooled pump with a suction speed of 3,1 m/s.
- Water connection** TRIPLE connection Ø 9,5/12,3 mm John Guest fittings.
- Operation** Power supply 220-240 Volts - 24 hours a day non stop. Clean non drinkable water only.
- Regulations** Complying with EN60335-2-41:2003/A2:2010 and WEEE/RoHs directives.
- Note** **PATENTED device.** Read the instruction booklet for correct set up and use.

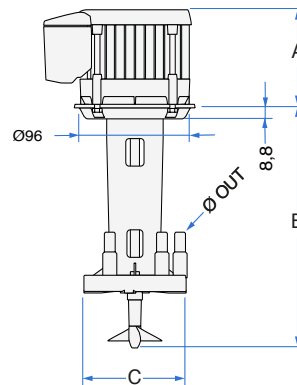
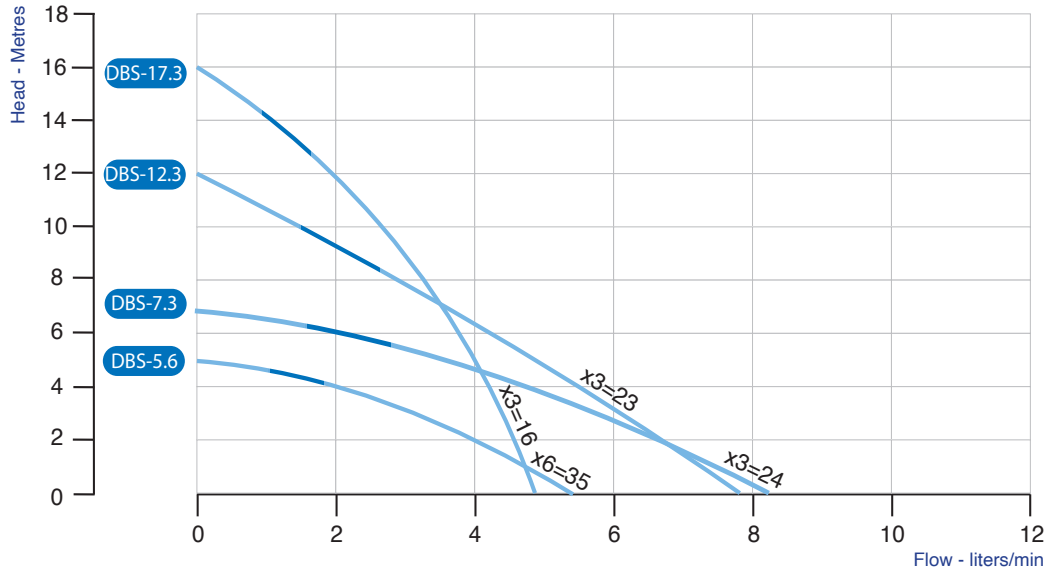

DBS is available in 3 and 6 outlets

TYPE	Volt	Hz	Amp	Watt (in)	RPM	A	B	C	Ø OUT	Propeller Ø [mm]	Weight [Kg]
DBS-5.6	220-240	50	0,30	73	2800	95	204	90	9,5	66x15° 2 Blades	1,9
DBS-7.3	220-240	50	0,28	61	2890	95	198	90	9,5/12,3	50x15° 2 Blades	1,8
DBS-12.3	220-240	50	0,41	95	2700	95	198	90	9,5/12,3	50x15° 2 Blades	1,9
DBS-17.3	220-240	50	0,53	114	2850	111	198	90	9,5/12,3	50x15° 2 Blades	2,5