

DBS-M series upgrades the standard DBS pump, adding a **probe** able to sense the tank's temperature and adjust the motor's speed. This saves the ice bank **reducing the whole system energy consumption** while ensuring a constant beverage quality. Additional options available on demand.

DBS-M1

TECHNICAL SPECIFICATIONS



Category	AGITATOR-PUMP with immersed vertical axis.
Windings	Single-phase motor. Insulation Class F.
Motor body	Extruded aluminium casing.
Protection	IP 44 ingress protection rating.
Safety	Built-in thermal motor protection system.
Ball bearings	Ø 8 mm NSK, SKF or equivalent, in semi-rigid noise-damping silicone casing.
Motor shaft	AISI 303 INOX steel Ø 8 mm.
Fastening parts	INOX steel or corrosion-resistant materials.
Motor parts	Thermoplastic motor parts resistant to high temperature.
Cooling system	Air cooled pump with a suction speed of 3,1 m/s.
Water connection	Compatible with John Guest fittings.
Operation	Power supply 220-240 Volts - 24 hours a day non stop. Clean non drinkable water only.
Regulations	Complying with EN60335-2-41:2003/A2:2010 and WEEE/RoHs directives.
Note	PATENTED device. Read the instruction booklet for correct set up and use.



AVAILABLE FIXING PLATES

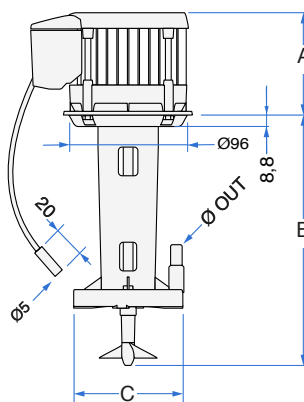
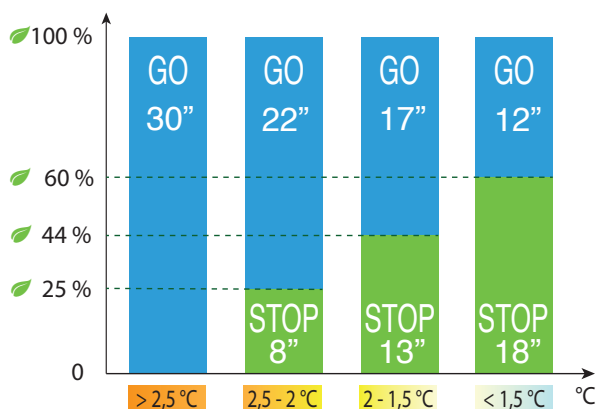
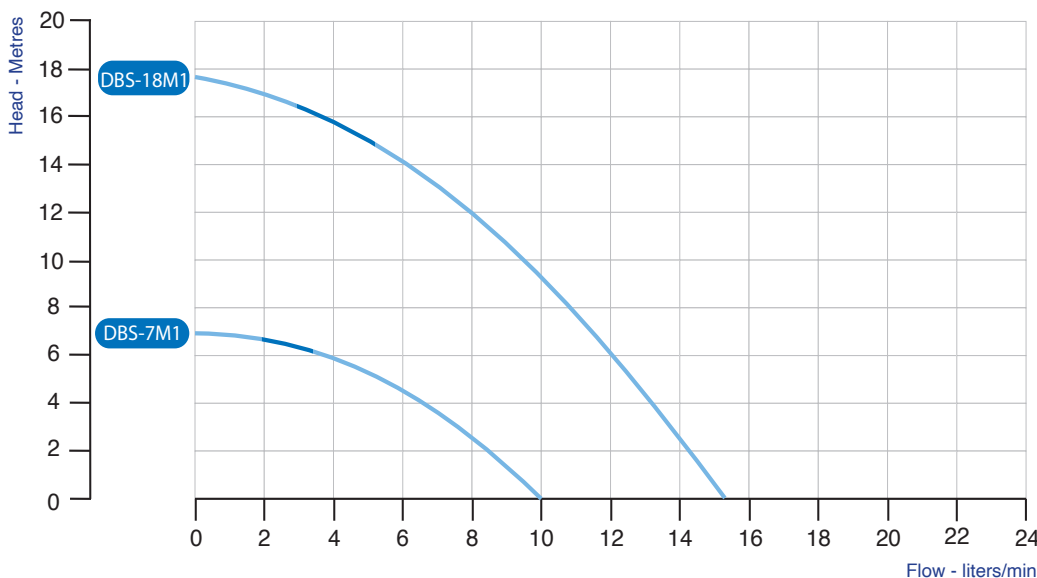
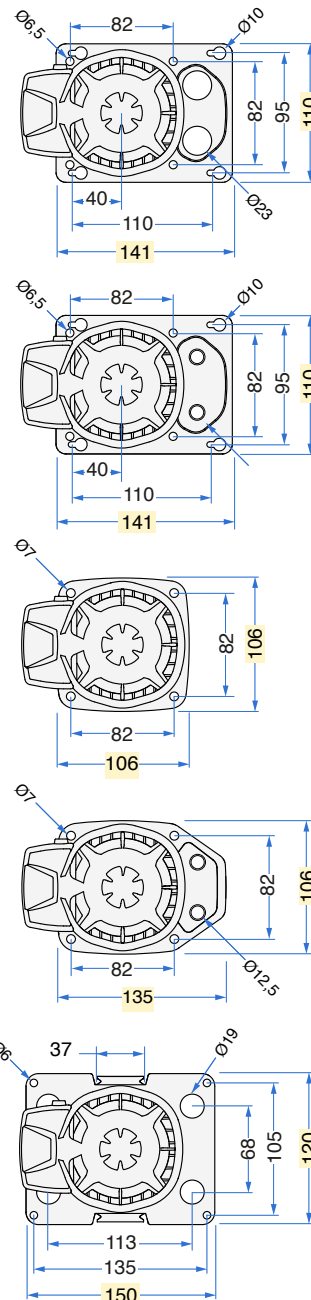

TYPE	Volt	Hz	Amp	Watt (IN)	RPM	A	B	C	Ø OUT	Propeller Ø [mm]	Weight [Kg]
DBS-7M1	220-240	50	0,18	43	2800	82	195	90	9,5	50x15° 2 Blades	1,7
DBS-18M1	220-240	50	0,46	99	2900	111	232	90	9,5	50x15° 2 Blades	1,8